

NOVOFLEX

Cable Ties - Series - CPR

High performance ties for extreme environments



CPR Series- After undergoing extensive and continuous development, a new range of Reusable Cab Lok Cable Ties, series CPR has been developed. These reusable Cab-lok Cable Ties remain securely locked until released by pushing the tab near the locking head. They are suitable

for servicing and for situations where wiring amendments need to be made.

CPU Series - These ties are easily assembled by hand and remain locked until intentionally released by the finger catch at the head.



Material: Nylon 6.6 resistant to fungus, corrosion.
Standard Colour : Natural Colour or weather resistant Black. Other colours on request subject to a minimum quantity.
Operating Temperature :
-25° C to +85° C

Standard Packing : 100 Nos.
Tensile Strength : High Tensile Strength provides a secure locking which will not slip, come off or slacken.
Manufactured from UL approved Nylon 6.6 V-2 Rating.

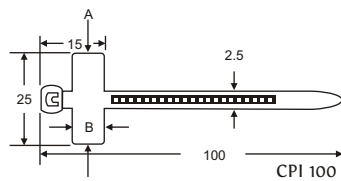

Re-usable Cab-Lok Cable Ties-Series-CPR

Novoflex Part No.	Nominal length L (mm)	Strap width B (mm)	Thickness A (mm)	Min. Tensile strength (Kg)	Max. Cable bundle dia. (mm)
CPR - 100 ES	100	3.5	1.2	9	24
CPR - 150 ES	150	4.5	1.2	14	35
CPR - 200 ES	200	4.7	1.2	20	51
CPR - 300 ES	300	4.8	1.3	20	83
CPR - 370 ES	370	4.8	1.3	20	106

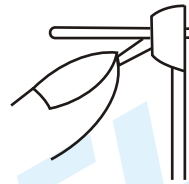

Exclusive design permits fast, easy release & reuse

Re-usable Cab-Lok Cable Ties-Series-CPU

Novoflex Part No.	Nominal length L (mm)	Strap width B (mm)	Thickness A (mm)	Min. Tensile strength (Kg)	Max. Cable bundle dia. (mm)
CPU - 150	150	7.5	1.7	20	35
CPU - 200	200	7.5	1.7	20	51
CPU - 300	300	7.5	1.7	20	83

NOVOFLEX Identification Cable Ties

Just one operation is required for both tying and identifying bundles of cables.

They can also be used to identify pipes and other components.

Tag marking is carried out by hot foil printing or with a permanent marking pen.

All other features of cab - lok cable ties.

Standard colour : Natural White.

Material : Nylon 6.6 resistant to fungus, corrosion.

Novoflex Part No.	Nominal length L (mm)	Plate		Strap width C (mm)	Standard Packing
		A (mm)	B (mm)		
CPI 100	100	25	7.9	2.5	100 nos.
CPI 200	190	12.8	29	4.8	100 nos.