

Adhesive Backed PCB Support



Novoflex Adhesive Backed PCB Support are designed for fixing PCB to chassis in all types of electronic equipments. This PCB support is ideal where there is no possibility of making holes in chassis. PCB is installed just by snapping into the PCB support. It is available with a spacing distance of 9.7 mm.

Material: Nylon 6 (Polyamide). Resistant to Fungus, Corrosion, and most mild acids.

Flammability Rating: UL94 V-2

Standard Colour: Natural White.

Continuous Operating Temperature: -25° C to +85° C.

Storage Conditions: To be stored in a cool, dark, dry place away from sunlight in a sealed condition.

Example Applications: Automobiles, Railways, Aviation, Ship Building, Power Plants, Telecom, Consumer Durables, Retail Stores, Computers & Networking, Electric Metering, Electronics, Control Panels, New Project Installations, and many more.

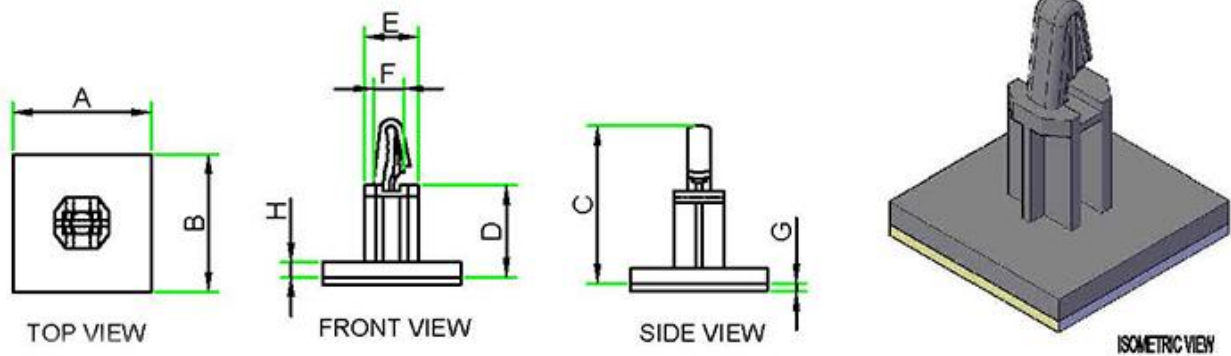

NOVOFLEX - Adhesive Backed PCB Support

Novoflex Part No.	Length (A) - mm	Width (B) - mm	Height (C) - mm	Spacing Length (D) - mm	Spacer Dia (E) - mm	Lock Head Dia (F) - mm	Adhesive Thickness (G) - mm	Base Thickness (H)	Standard Packing (Nos)
PCBA 97	18	17.8	20.5	12	7.1	4.5	1	2	100