

Locking Style PCB Supports

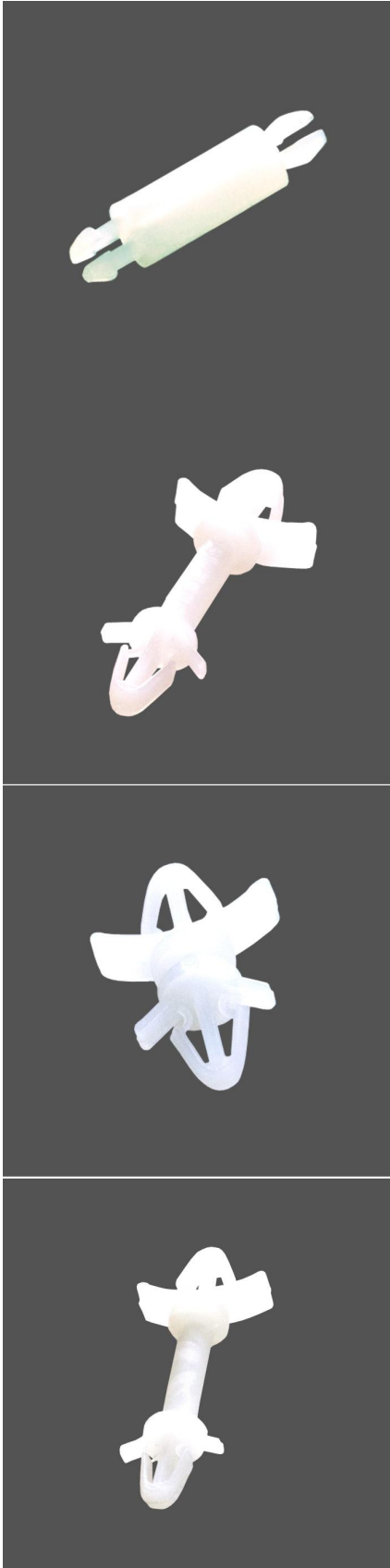

Novoflex Locking Style PCB Supports are non-conductive, non-magnetic PCB Supports and are designed to fit in 4 mm diameter hole in PCB and 4.8 mm diameter hole in chassis of 0.8 to 2 mm thickness. These supports are also mounted easily just by snapping into the board. It is available in 9 standard spacing heights.

Material: **Nylon 6 (Polyamide)**. Resistant to Fungus, Corrosion and most mild acids.

Tolerance: ± 0.50 mm.

Flammability Rating: **UL94 V-2**

Standard Colour: Natural White.

Continuous Operating Temperature: -25° C to $+85^{\circ}$ C.

Intermittent Operating Temperature: $+115^{\circ}$ C.

Storage Conditions: To be stored in a cool, dark, dry place away from sunlight in a sealed condition.

Example Applications: Automobiles, Railways, Aviation, Power Plants, Telecom, Consumer Durables, Retail Stores, Electric Metering, Electronics, Control Panels and many more.



TOP VIEW

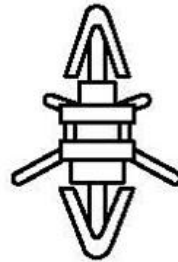

FRONT VIEW

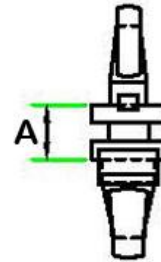

SIDE VIEW

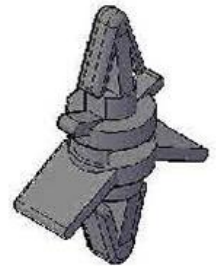

ISOMETRIC VIEW



NOVOFLEX - Locking Style PCB Supports

Novoflex Part No.	Spacing Height (A) - mm	Lock Hole Dia PCB - mm	Hole Dia Panel - mm	Panel Thickness - mm	Standard Packing (Nos.)
PCBL 48	4.8	4	4.8	0.8 -2.0	100
PCBL 64	6.4	4	4.8	0.8 -2.0	100
PCBL 95	9.5	4	4.8	0.8 -2.0	100
PCBL 111 (S)	11.1	4	4.8	0.8 -2.0	100
PCBL 159	15.9	4	4.8	0.8 -2.0	100
PCBL 191	19.1	4	4.8	0.8 -2.0	100
PCBL 222	22.2	4	4.8	0.8 -2.0	100
PCBL 286	28.6	4	4.8	0.8 -2.0	100
PCBL 318	31.8	4	4.8	0.8 -2.0	100
PCBL 349	34.9	4	4.8	0.8 -2.0	100

