

### Push Rivet



Novoflex Push Rivet is designed to hold together two or more panels securely, attractively and economically. They are suitable for fastening most materials including metal, wood, hardboard, rubber, glass, plastic etc. Due to special design wings they have excellent mechanical properties.

**Material :Nylon 6 (Polyamide)**

**Flammability Rating: UL94 V-2**, Resistant to Fungus, Corrosion, and most mild acids.

**Standard Colour : Black**

**Operating Temperature : -25° C to +85° C**

**Storage Conditions :** To be stored in a cool, dark, dry place away from sunlight in a sealed condition.

**Example Applications :** Automobiles, Railways, Aviation, Couriers & Logistics, Ship Building, Pharmaceutical & Drugs, Chemicals & Dyes, Power Plants, Telecom, Consumer Durables, Retail Stores, Computers & Networking, Food Processing, Electric Metering, Electronics, Control Panels, New Project Installations, Domestic Use and many more.

**Push Rivet Application:**

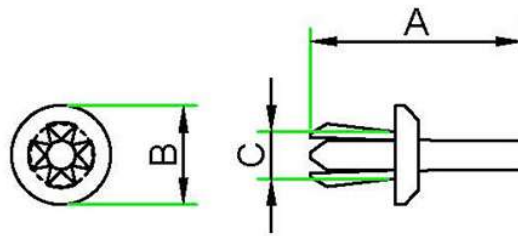

TOP VIEW

FRONT VIEW

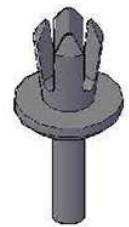

ISOMETRIC VIEW

#### NOVOFLEX - Push Rivet

Novoflex Part No.	Length (A) - mm	Rivet Dia (B) - mm	Hole Dia (C) - mm	Total Material Thickness Range - mm	Standard Packing (Nos.)
PR 01	20	9.3	4.4	2.0 - 5.0	100
PR 02	25.6	11.5	6.2	4.0 - 8.0	100