

### Cable Tie Plug – Screw



Novoflex Screw Cable Tie Plug is designed with a deep anchor and can go deep into your chassis/panel providing unmatched support. Cable Ties can then be used to secure cables.

**Material: Nylon 6 (Polyamide).**Resistant to Fungus, Corrosion and most mild acids.

**Flammability Rating: UL94 V-2**

**Standard Colour: Black**

**Operating Temperature: -25° C to +85° C.**

**Storage Conditions:** To be stored in a cool, dark, dry place away from sunlight in a sealed condition.

**Example Applications:** Automobiles, Railways, Aviation, Couriers & Logistics, Ship Building, Pharmaceutical & Drugs, Chemicals & Dyes, Power Plants, Telecom, Consumer Durables, Retail Stores, Computers & Networking, Food Processing, Electric Metering, Electronics, Control Panels, New Project Installations, Domestic Use and many more.

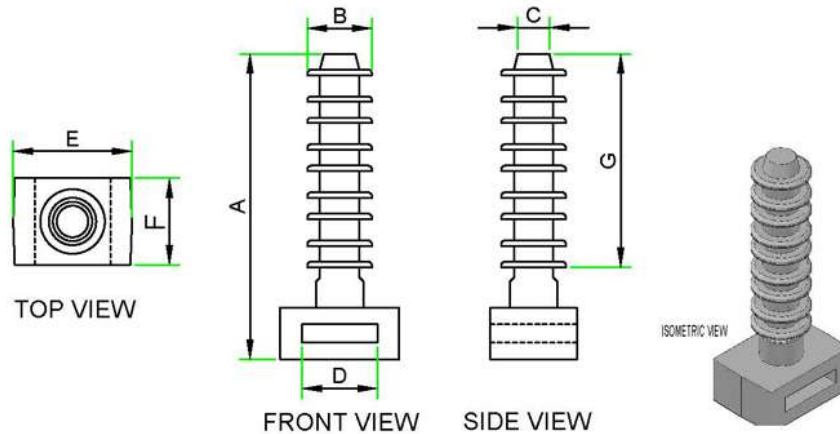

Novoflex Part No.	Length (A) mm	Lock Head Dia (B) mm	Anchor Head Dia (C) mm	Max Cable Tie Width (D) mm	Base Width (E) mm	Base Length (F) mm	Serration Length (G) mm	Push Hole Dia (mm)	Standard Packing (Nos.)
CPT 01	38.8	8.2	4	9.5	15.1	11	25.2	7.5	100